

# Silflex®

## Soft silicone wound contact layer

### Product description

A wound contact layer made from polyester mesh coated with Silfix® soft silicone.

Silflex® is designed to gently adhere to the skin surrounding a wound and not to the wound bed this minimises the pain and trauma associated with dressing change. The dressing allows the passage of exudate.

### Use

Remove the clear liners on each side of the dressing and place directly over the wound. Silflex® may overlap the wound edges. The dressing can be cut to size ensuring that sharp scissors are used. Cover with a secondary dressing of choice which may be an absorbent pad or film dressing. Silflex® may be kept in place for up to fourteen days depending on the wound condition.

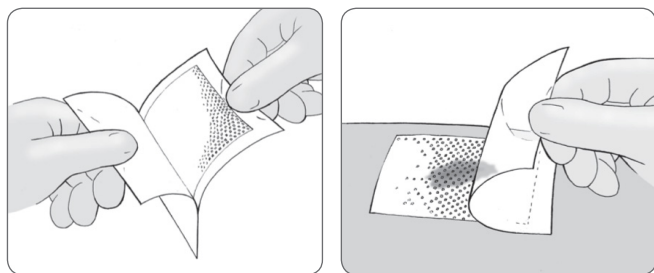

### Contra-indications

Do not use if allergic to silicone.

### Storage

Store at room temperature, out of direct sunlight and keep dry.

### Ordering information for Silflex®

Size	Stock code	Pack size
5cm x 7cm	CR3922	10
8cm x 10cm	CR3923	10
12cm x 15cm	CR3924	10
20cm x 30cm	CR3925	10
35cm x 60cm	CR4006	5

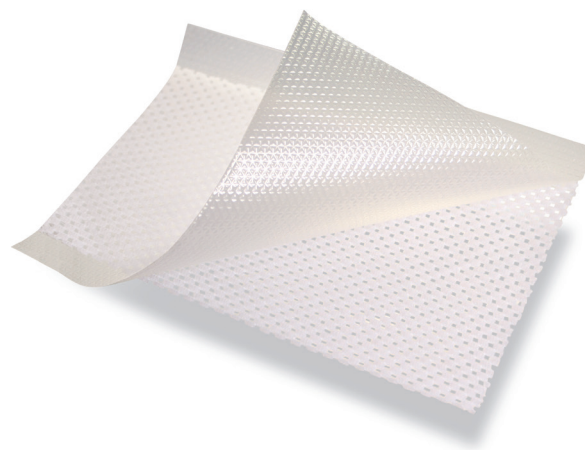

### Features

- ✔ Adheres only to dry skin not to a moist wound
- ✔ Atraumatic soft silicone, reduced pain on dressing change
- ✔ Allows passage of exudate
- ✔ Hydrophobic Silfix® soft silicone coating
- ✔ Soft and conformable

### Indications

- ✔ Skin tears
- ✔ Skin abrasions
- ✔ Surgical wounds
- ✔ Second degree burns
- ✔ Lacerations
- ✔ Leg and pressure ulcers
- ✔ Topical negative pressure (primary dressing)

### Care and use symbols

	Read instructions for use		CE marked medical device
	Single use only		Keep dry
	Do not use if packaging is broken or damaged		Store out of direct sunlight
	Sterilised using ethylene oxide		Do not re-sterilize



#### TOP TIP

Wet your hands/gloves before application so that the Silflex® doesn't stick when applying.

Distributed throughout Australia by:

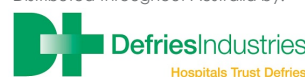

Hospitals Trust Defries  
T: 03 9706 3600 | Freecall: 1300 550 278  
Email: sales@defries.com.au [www.defries.com.au](http://www.defries.com.au)

